

5134647

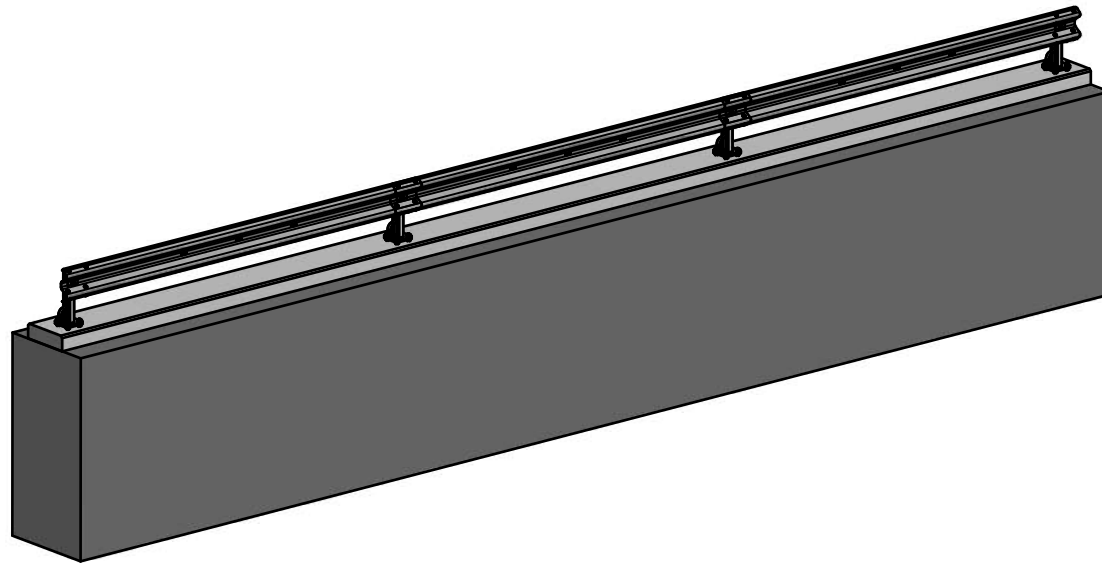
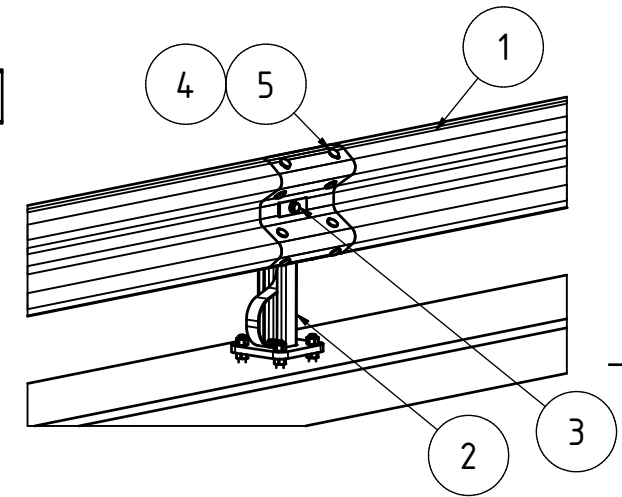
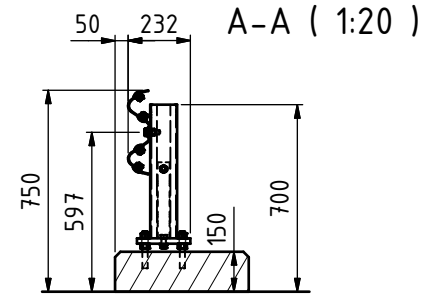
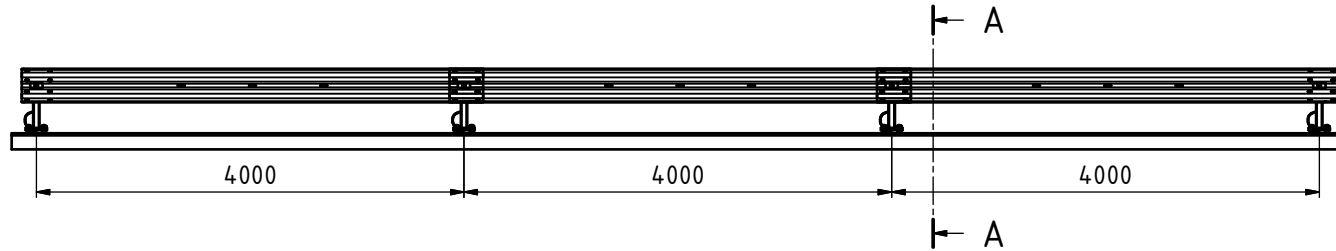

5	8 / 4m	Splice bolt M16X25 4.6 VFZ	0,1 kg	60641
4	8 / 4m	Flange nut DIN 692 M16 VFZ 8.8 Isofit	0,1 kg	692316000
3.4	1 / 4m	Nut DIN 934 8 M16 VFZ	0 kg	60643
3.3	1 / 4m	Washer DIN 125 17/30/3 M16 VFZ	0 kg	60642
3.2	1 / 4m	Washer M16 4-KT 18/115x40x5 VFZ	0,2 kg	60981
3.1	1 / 4m	Bolt DIN 933 8.8 M16x45 VFZ	0,1 kg	933316045
3	1 / 4m	Festesats M16x45 Kpl	0,3 kg	60613
2	1 / 4m	Vik ep post with baseplate L=520 KIT	10,4 kg	60286
1	1 / 4m	A-profile beam 310 L= 4,0 m, 3 mm, S355	46,1 kg	60066
Item No.	Qty.	Description	MASS	Note

Torque on bolt connections		
Item No.	Description	Torque [Nm]
3,4,5,6	railing/post	140
7,8	railing/railing	70

Date 16.09.2021	Constr./Drawn by AT	Scale A3 - 1 : 50	Sheet # 1 / 1	 a SAFEROAD® company
Calculation	Approved by JHS		Weight 14,9 kg/m	
Vik EP Roadside Barrier				5134647
Vik EP N2/H1 cc4 with baseplate on 150 mm plinth				
System drawing				Revision -
Reference:		Replacing	Replaced by	This drawing is the property of Saferoad and must not be used, copied, or made available to others without our consent.

Rev.	Revision Description	Sign.	Date

5134647.idw

© VIK ØRSTA A SAFEROAD COMPANY