

Finger

Assembly of floats at walkable finger.

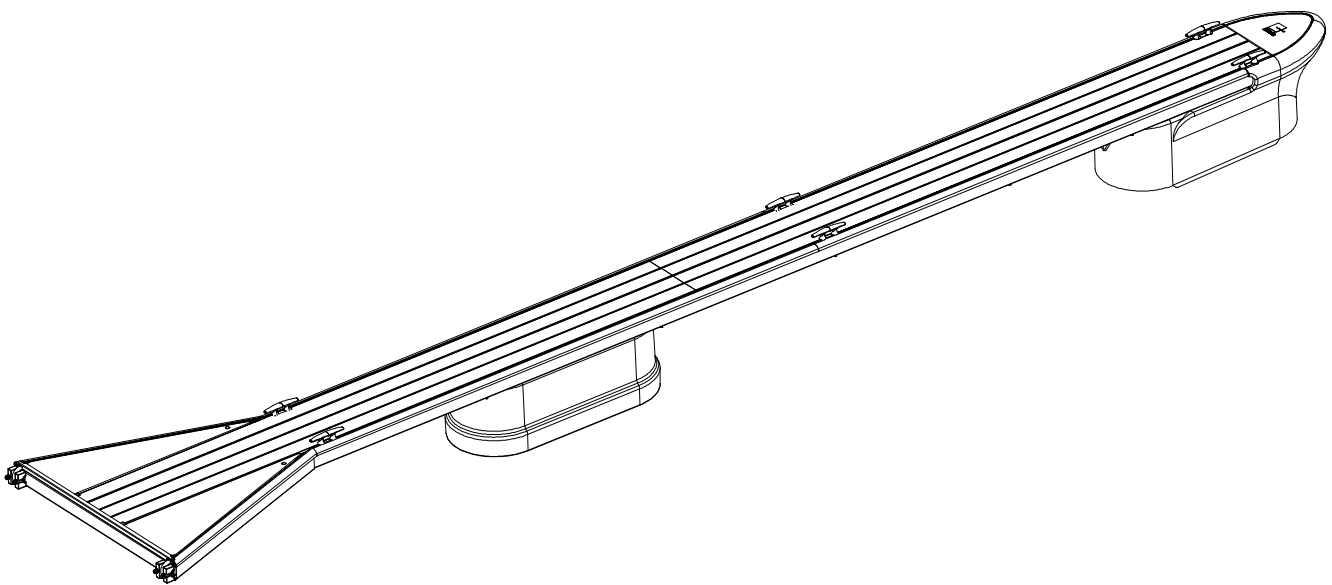

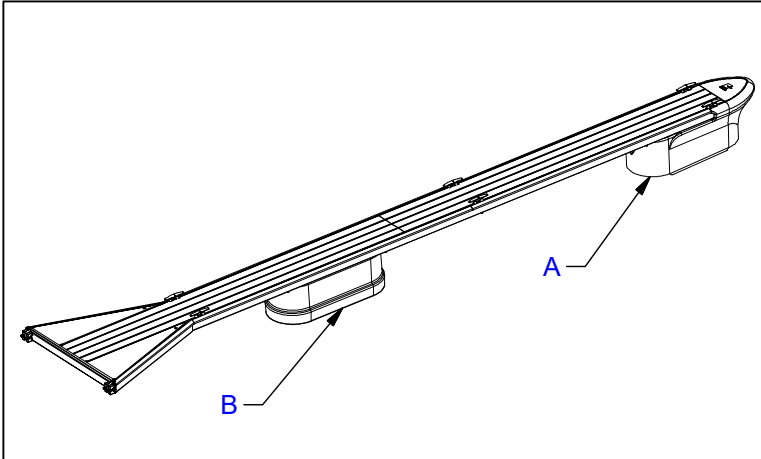

Necessary equipment:

Prestressing factor:
M16 =



Spanner for: M16 (24mm)

NB!

- Do not tighten until deformation of any steel or plastic parts.
- Do not put the steel construction directly at the ground to prevent damage at the surface.

PARTS for: A

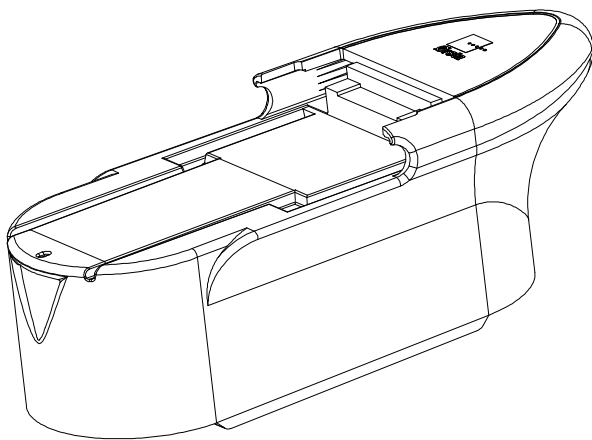

Item 1 x 1
Float
Art. nr. 5001130

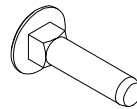

Item 2 x 1
Locking bolt M16x70 - DIN603 VZ
Art. nr. 4216070



Item 3 x 1
Nut M16 - DIN985 VZ
Art. nr. 4912016

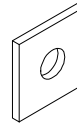

Item 4 x 1
Square Washer M16 - DIN436 VZ
Art. nr. 4816004

PARTS for: B

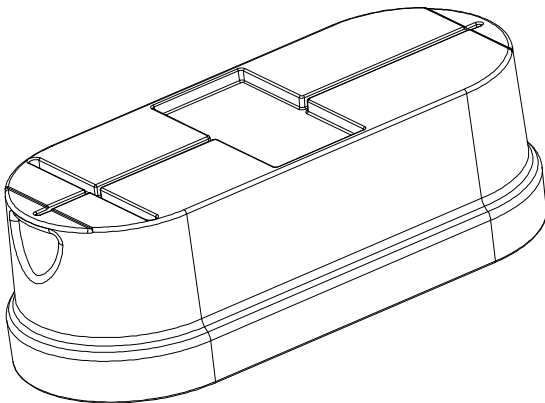

Item 5 x 1
Float
Art. nr. 5001129

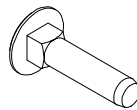

Item 2 x 2
Locking bolt M16x70 - DIN603 VZ
Art. nr. 4216070



Item 3 x 2
Nut M16 - DIN985 VZ
Art. nr. 4916008

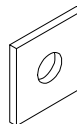

Item 4 x 2
Square Washer M16 - DIN436 VZ
Art. nr. 4816004

A End float

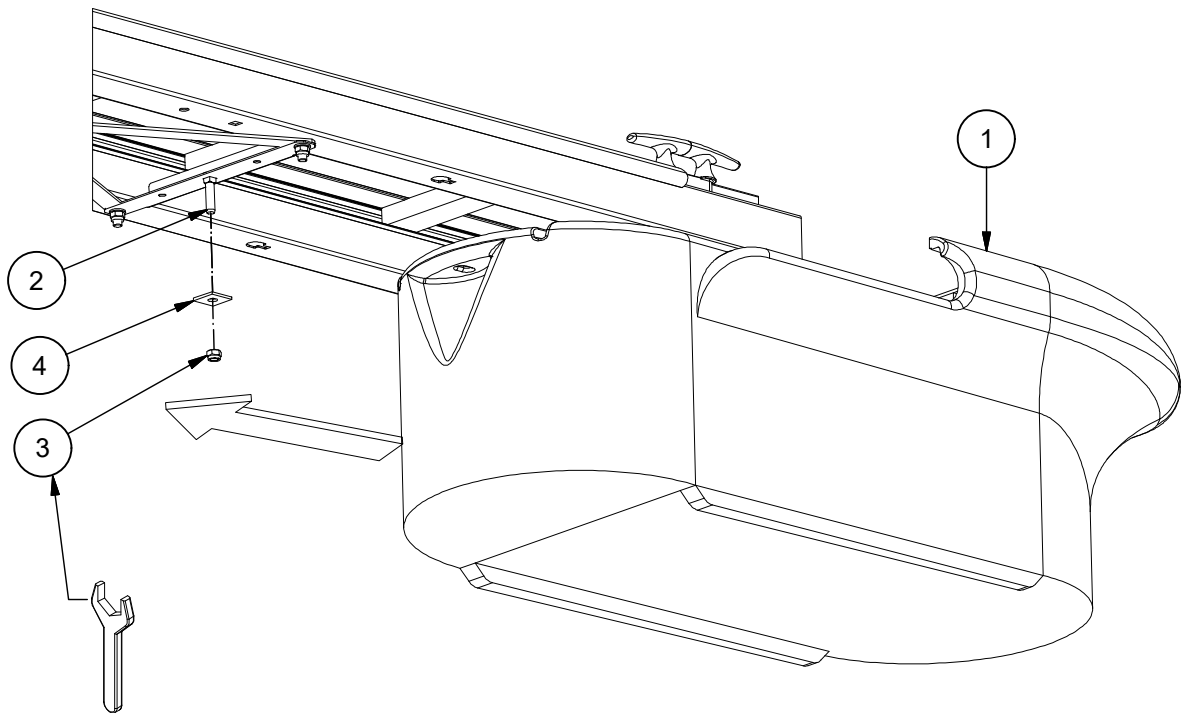

Spanner for: M16 (24mm)

B Extra float

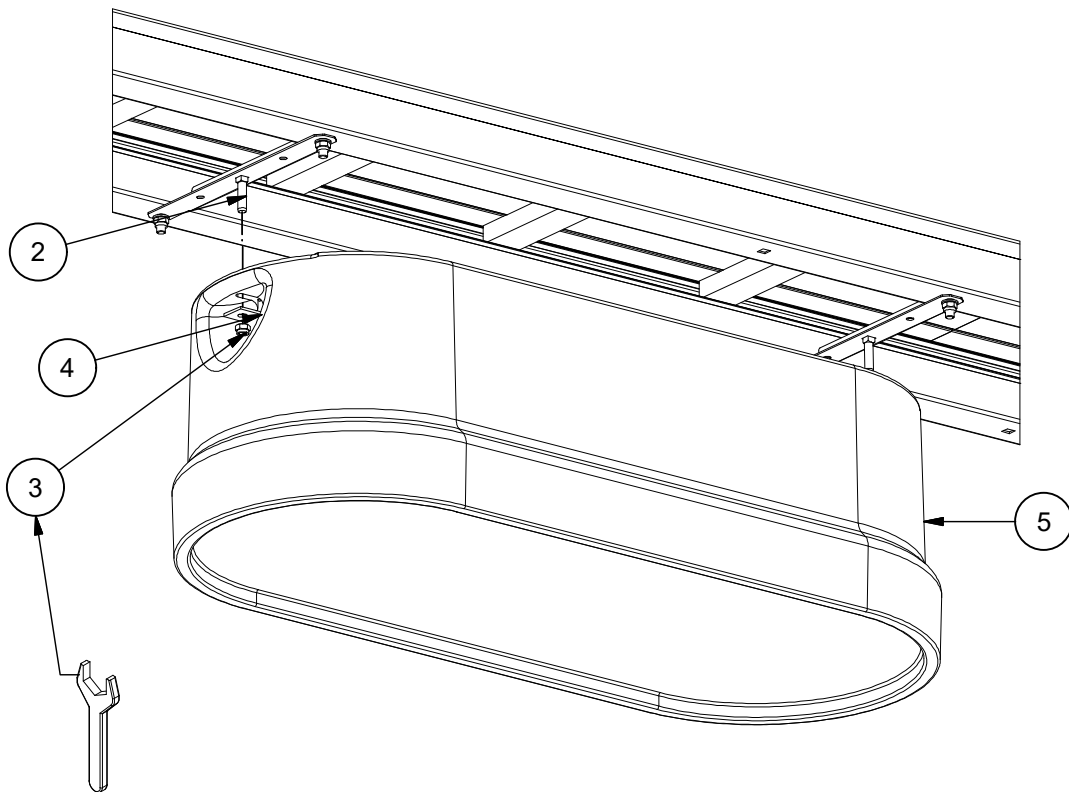

Spanner for: M16 (24mm)