

Cap Nut

Securing the gangway's entering plate

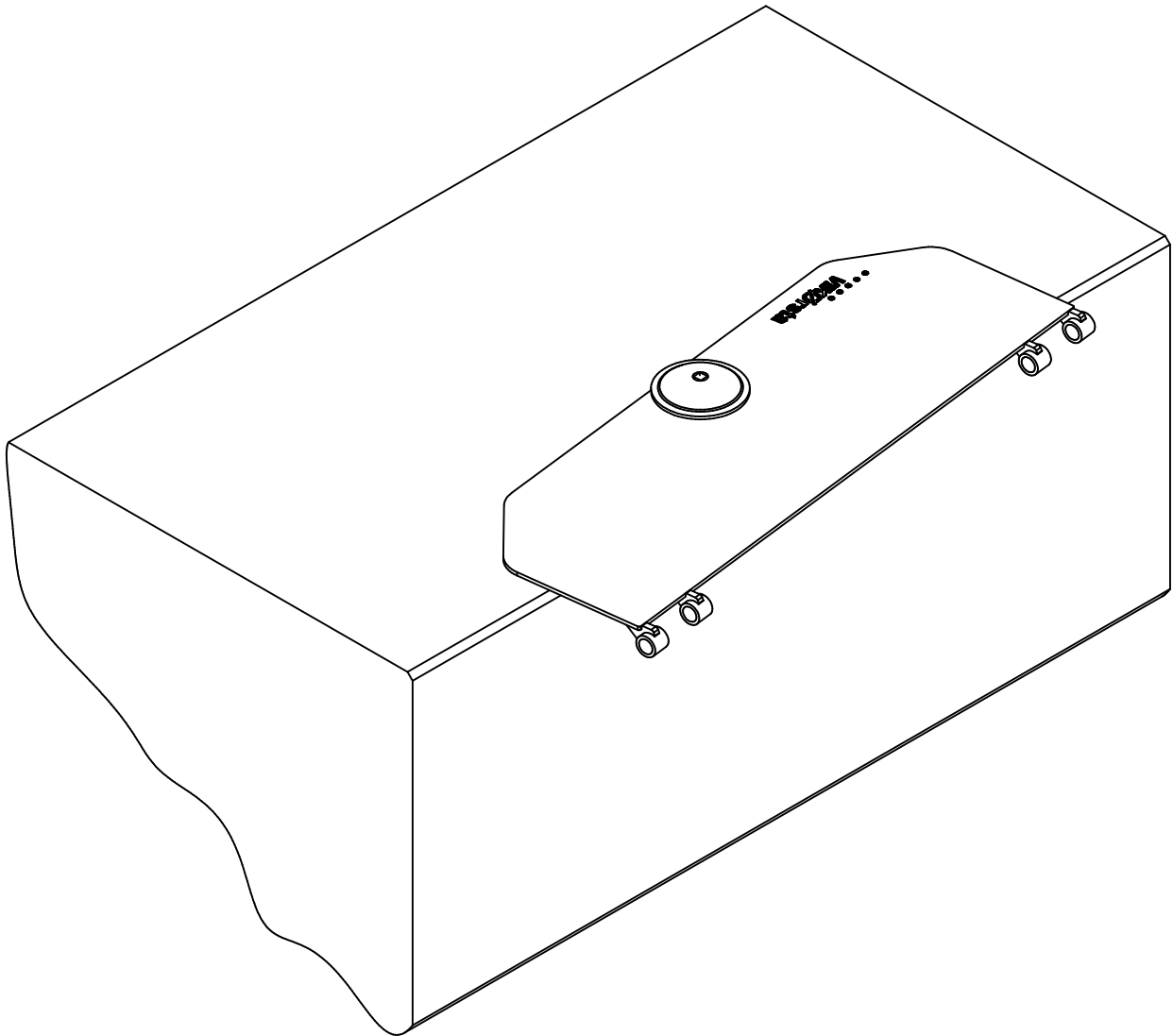

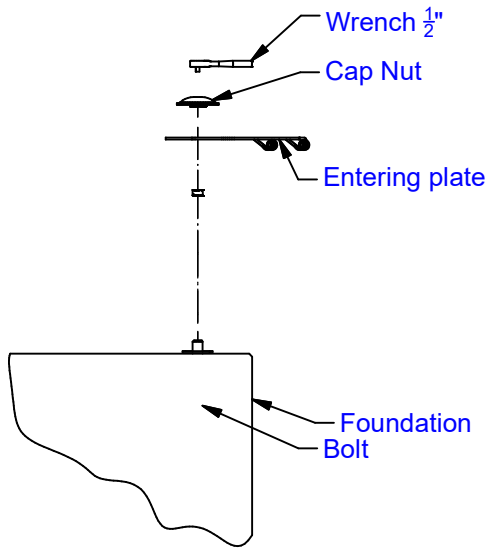

Necessary equipment:



Spanner for M33

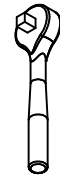

1/2" Wrench

NB!

- Do not tighten until deformation of any steel parts.
- Do not put the steel construction directly at the ground to prevent damage at the surface.

Parts

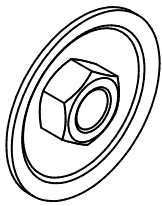

Item 1
Art. no.: 5001487C
Cap nut

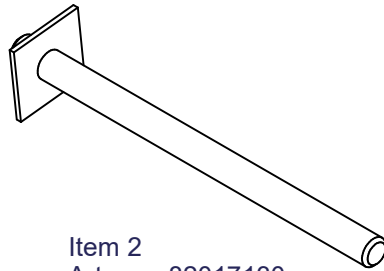

Item 2
Art. no.: 82017130
Bolt

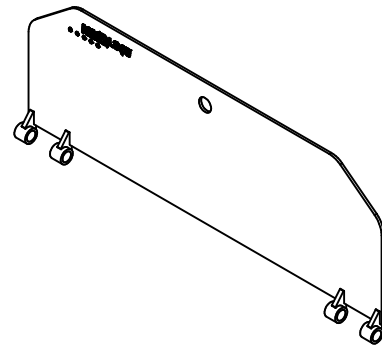

Item 3 - Entering plate

Art. no.:	Qty.	Type
5001470 CC	1	1m for 150kg/m
5001520 CC	1	1,5m for 150kg/m
5001546 CC	1	1,5m for 200kg/m



Item 4
Art. no.: 4934008
M33 DIN 934 - VZN
(Use only for wooden dock)

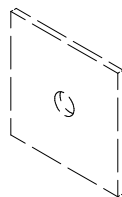

Item 5
Art. no.: 5001486C
Plate
(Use only for wooden dock)



Item 6
Art. no.: 5001488
LOCTITE
9gr.

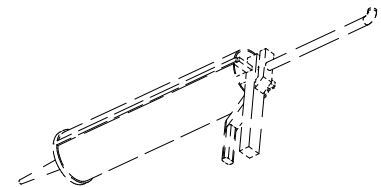

Item 7
Art. no.: 5002417
(Use only when drilling in concrete is necessary)

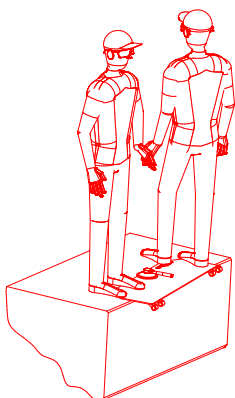

NB!

If you are about to loosen an existing cap nut make sure enough weight is placed on the entering plate to secure the gangway from falling.

Montering i betong

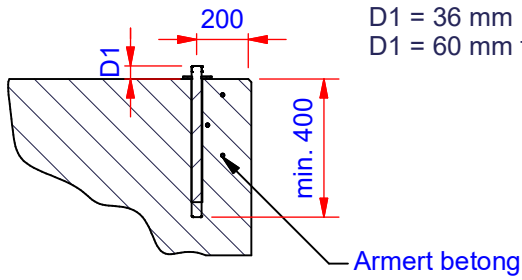

Støpes inne i betong, eventuelt limes med epoxy eller tilsvarende produkt med samme holdekraft. Sjekk produsentens datablad for temperatur/belastning

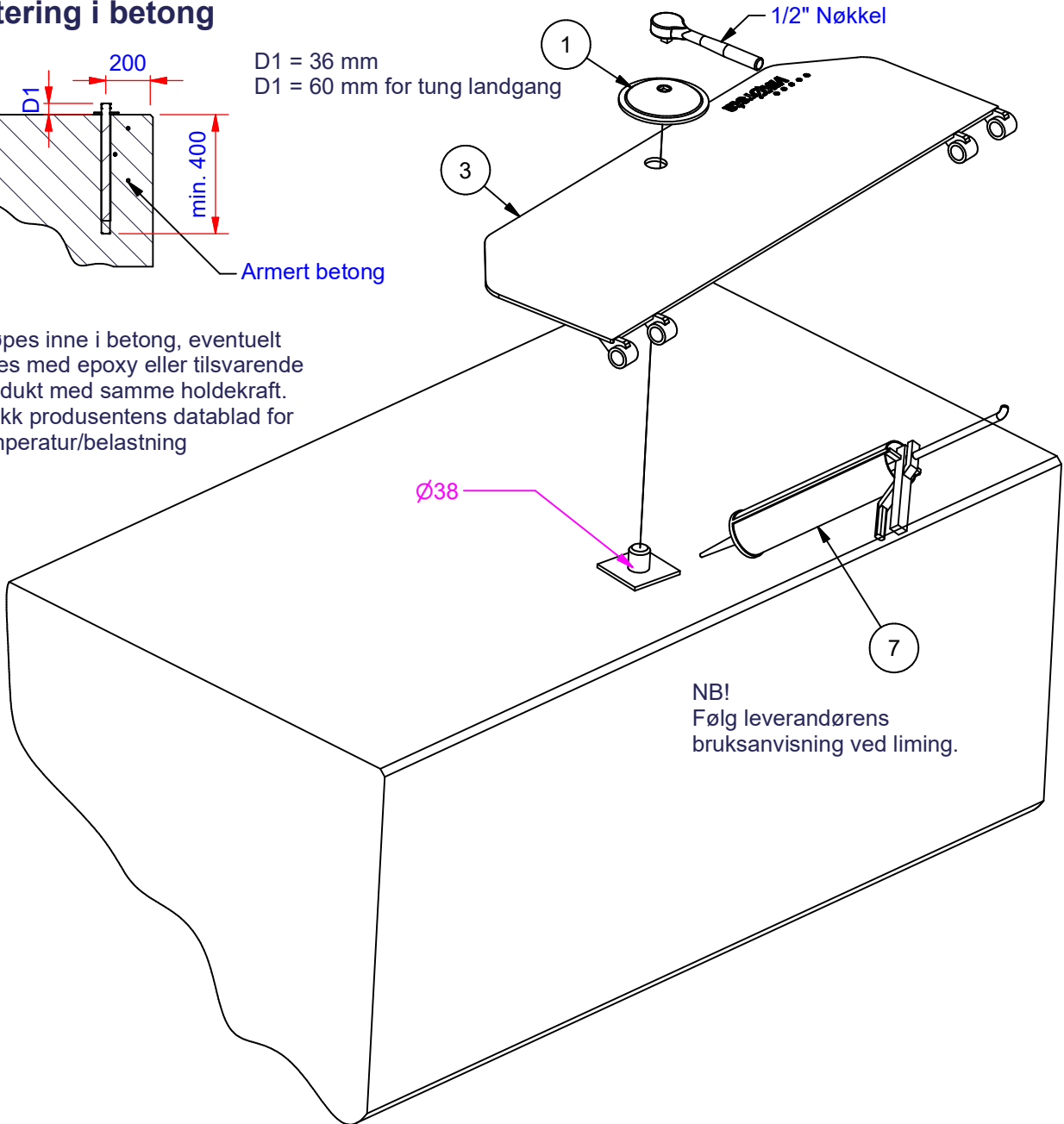

Før montering med LOCTITE må gjengene på bolten vaskes med spirit eller acetone.

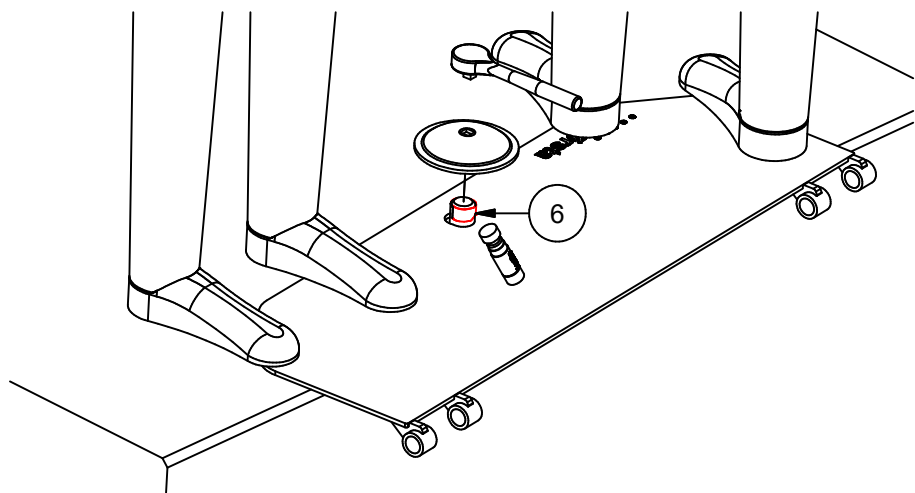
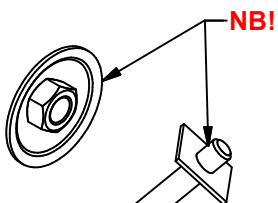

Assembly at wooden dock

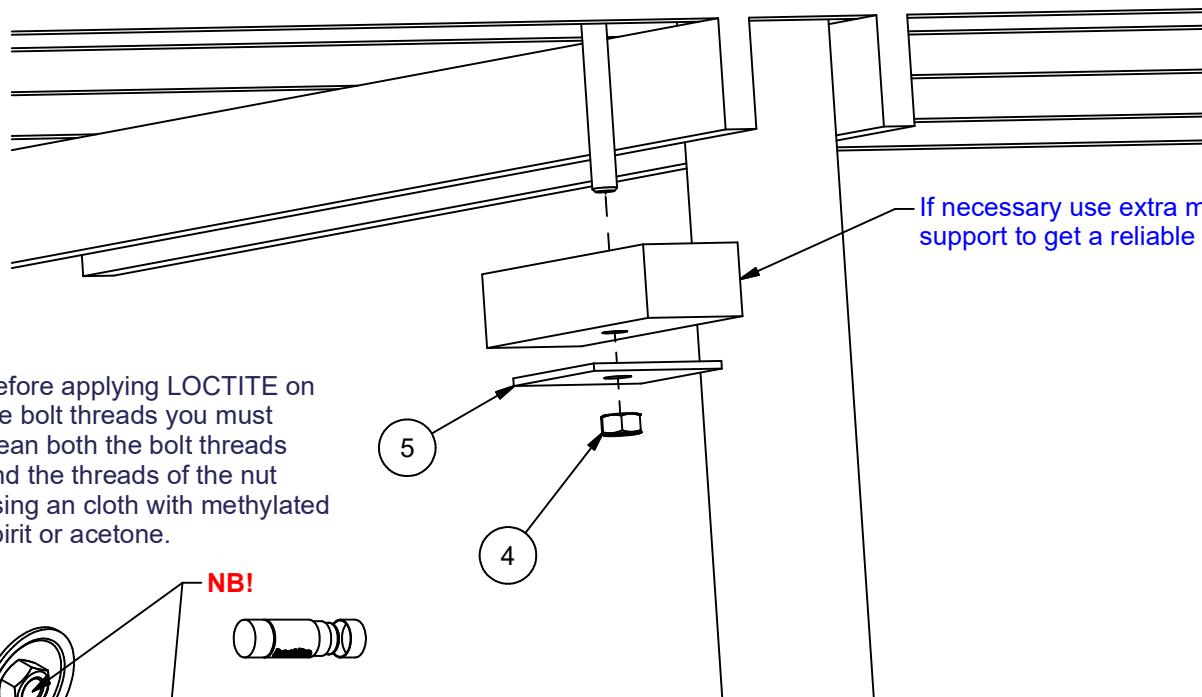
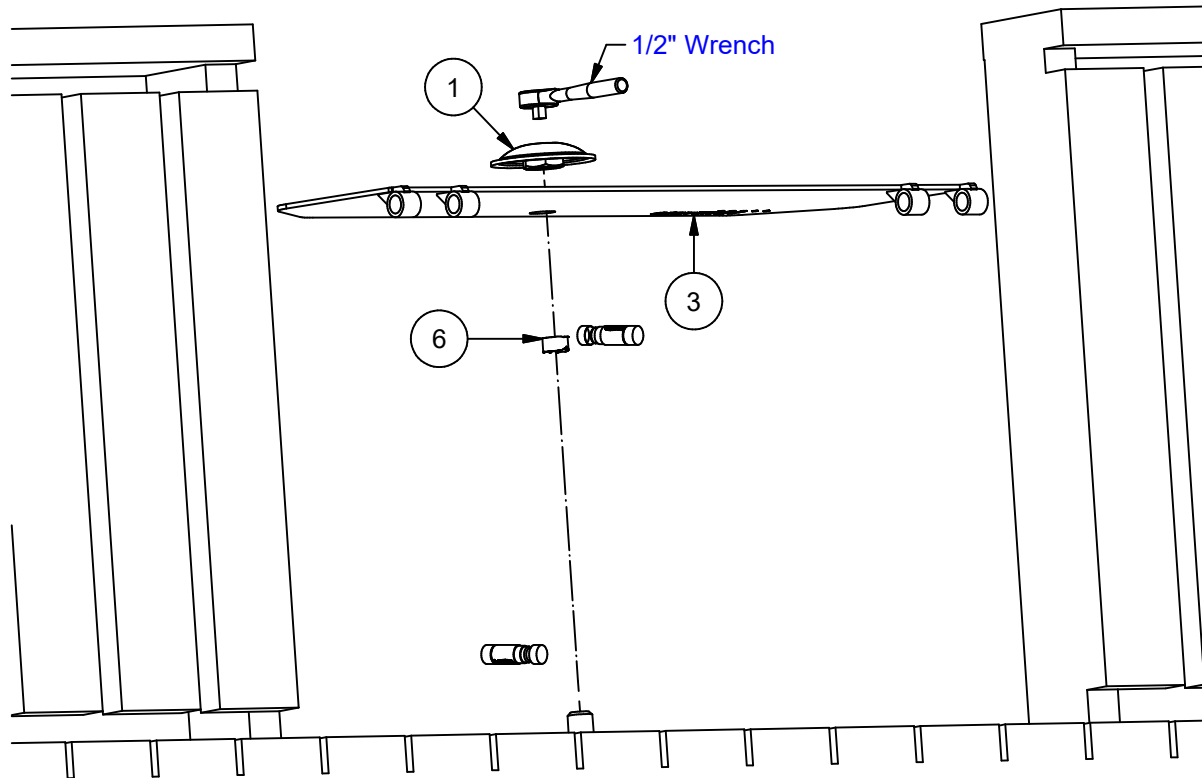

Before applying LOCTITE on the bolt threads you must clean both the bolt threads and the threads of the nut using a cloth with methylated spirit or acetone.

NB!

